

deeds: 47-77-Co. Records - Ethel S. Orth to Jos. B. Foulger Aug. 1-1904 -

Pl. Lot 6 - B 29 - P. A. O. C. S.

(J. F. Cutney and E. L. Short)  
assist

Req. M.W. Cir. Lot 6 -

592. ft. To point of beginning.

Running thence 340. ft. more or less to S line of said lot 6.

F 125. ft.  
W 40. ft. to point E. of beg.  
to Cray.

Sect 9-04

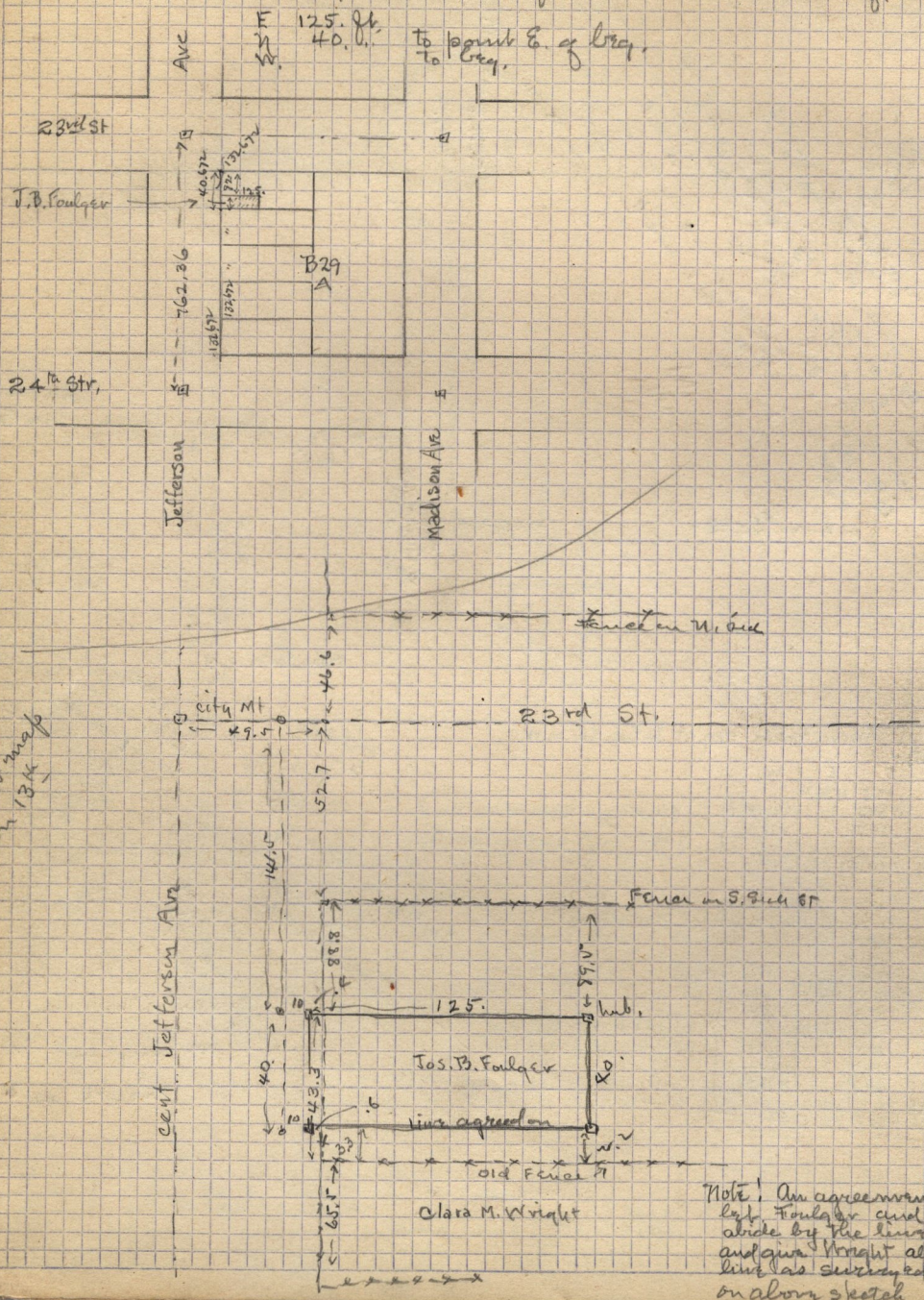

Sub map  
on 134

Note: An agreement was made by Jos. B. Foulger and Wright to abide by the line as surveyed and give Wright all S. of the line as surveyed and shown on above sketch